

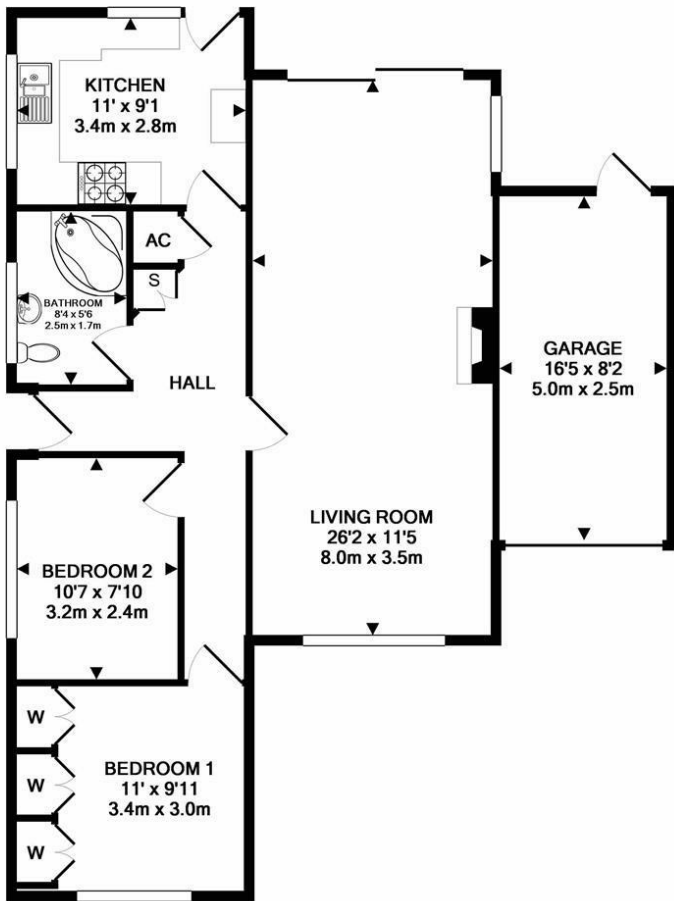

Keith
Ashton

Elmtree Avenue, Kelvedon Hatch
Brentwood



TOTAL APPROX. FLOOR AREA 879 SQ.FT. (81.7 SQ.M.)
THIS PLAN IS FOR ROOM IDENTIFICATION ONLY, AND ITS ACCURACY IS NOT GUARANTEED. www.epcsinessex.co.uk
Made with Metropix ©2019



1 Elmtree Avenue, Kelvedon Hatch, Brentwood, CM15 0BH

A two bedroom detached bungalow requiring modernisation, but with the benefit of having a good-sized garden backing onto open fields and being situated in a popular bungalow turning in the village of Kelvedon Hatch. Accommodation comprises : Two bedrooms, 26' through lounge, a large bathroom with corner bath suite, and a kitchen, along with a single attached garage. The property also has gas central heating via radiators, UPVC double-glazing and a large frontage with off street parking for up to four cars. Being offered for sale with immediate vacant possession and with the potential for extension to both the loft space and to the rear elevation (stpp)

Guide Price £495,000

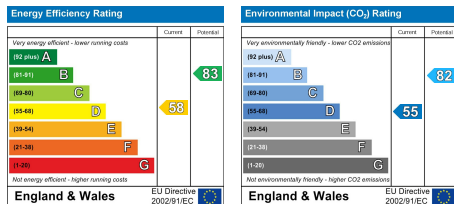

SERVICES:

Local Authority: Brentwood
Council tax band:
Post code: CM15 0BH

VIEWING:

Strictly by prior arrangement with Keith Ashton Estate Agents

OPENING HOURS:

Monday to Friday: 8.45AM - 6.30PM | Saturdays: 9AM - 5.30PM | Sundays: 10AM - 2PM

MORTGAGE INFORMATION:

We offer the additional facility of an in-house Independent Financial Adviser who will access all mortgage lenders with the purpose of providing you with the benefit of choice. For quotations or comparables please call 01277 375757 or visit our interactive website at www.mortgagebusiness.net



WE THE AGENT HAVE NOT TESTED ANY APPARATUS, FITTINGS OR SERVICES FOR THIS PROPERTY. THE PLOT SIZE IS INTENDED MERELY AS A GUIDE AND HAS NOT BEEN OFFICIAL MEASURED OR VERIFIED BY THE AGENT. PHOTOGRAPHS ARE FOR ILLUSTRATION ONLY AND MAY DEPICT ITEMS WHICH ARE NOT FOR SALE OR INCLUDED IN THE SALE OF THE PROPERTY.

Brentwood
Tel. 01277 260858

Village Office
Tel. 01277 375757

Lettings Office
Tel. 01277 202200

Explore more @ www.keithashton.co.uk